

GENERAL

The breather membrane is to be installed according to the manufacturer's instructions and the advice of the CSTC (Scientific and Technical Construction Centre).

During installation, the necessary measures are to be taken to remove rainwater from the exterior of the structural system. The contractor is to take all protective measures to prevent damage to the under-roof structure.

INSTALLATION TECHNIQUE:

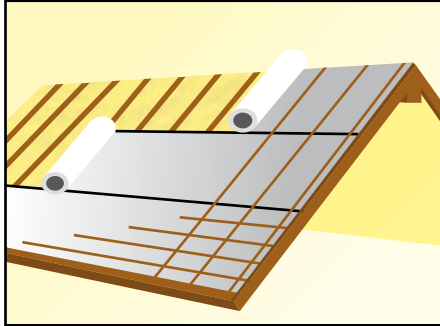

Aluthermo Roofreflex® consists of a silver-coloured reflective membrane and white polyester wool. The reflective membrane always faces the outside of the building whereas the polyester wool faces the inside. The first strip is unrolled parallel to the bottom of the roof. The lap joint with the built-in adhesive strip is always facing down.

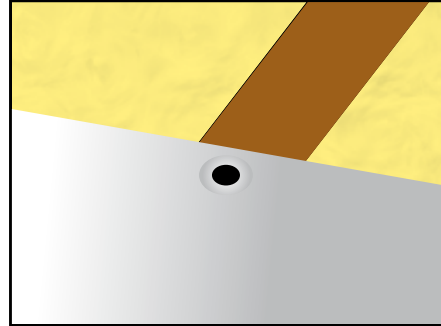

Temporary attachment is made about 3 cm from the upper edge of the lap joint by means of a nail with a wide head.

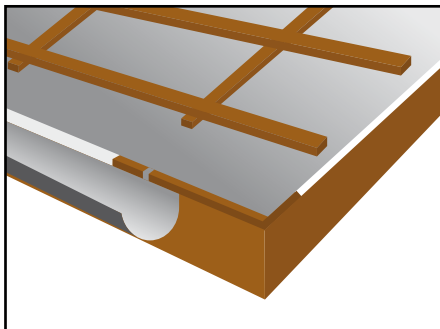

At the gutter, the lap joint with the adhesive strip is to cover the guttering and is attached to it with the adhesive strip. Care is to be taken to avoid any water bubbles or reverse slopes.

The second strip of Aluthermo Roofreflex® is unrolled parallel to the first, making sure that the polyester wool of each strip of Aluthermo Roofreflex® is placed edge to edge.

The lengthwise lap joint is then stuck together with the adhesive strip.

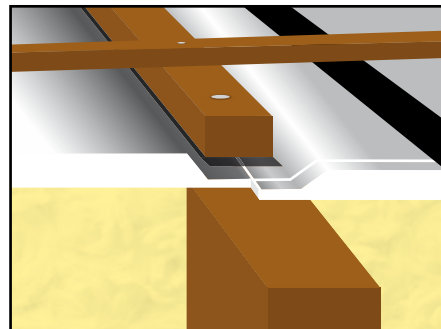

The vertical connection between two strips of Aluthermo Roofreflex® may be made as follows:

In order to make a lap joint, the polyester wool of the strip that is to be joined on is detached from the reflective membrane and shortened by about 20 cm along the entire width of the Aluthermo Roofreflex® using a knife, taking great care not to damage the reflective membrane.

Then the Aluthermo Roofreflex® is butted up to the first strip. The lap joint that you have just made is folded back.

Before gluing this lap joint with DAFA UV BLACK glue and to prevent any traction on the glue, the counter batten is put in place.

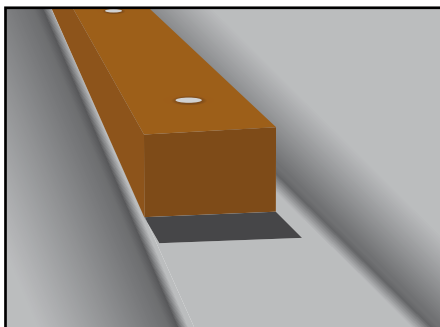

The counter battens must have a minimum thickness of 4 cm. Before they are put in place one should ensure that the sealing strip with DAFA Nageldichtband nails is placed between the counter batten and the Aluthermo Roofreflex®.

DETAILS:

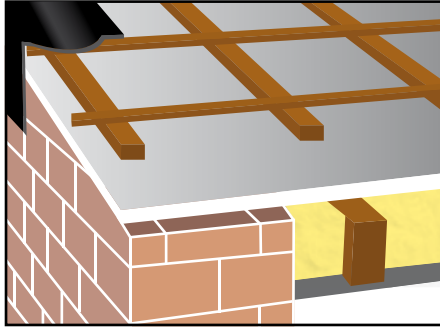

Installation at the gable:
The Aluthermo Roofreflex® ends at the outside vertical edge of the gable.

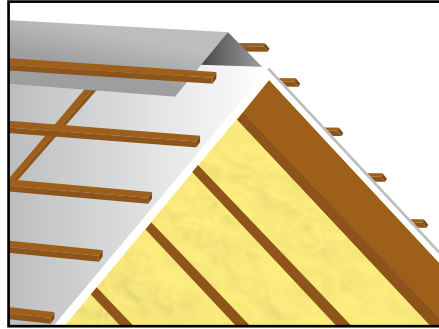

Installation at the ridge:
The Aluthermo Roofreflex® of the two slopes is positioned butted up to the ridge. The ridge is then covered with Roofreflex® jointing strip. The joints between this jointing strip and the Aluthermo Roofreflex® are sealed with DAFA UV BLACK.

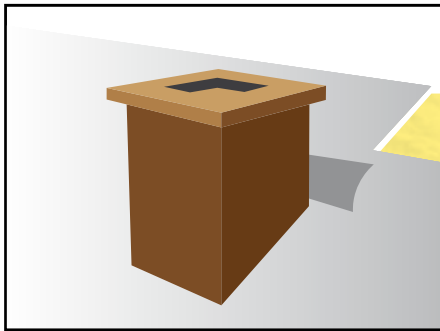

Chimney joints:
The Aluthermo Roofreflex® is placed along the chimney. To make the joint itself, Roofreflex® jointing strip should be used. This jointing strip is to come up to a height of at least 5 cm.
For the joint on the side facing the ridge, the jointing strip is to be slid under the Aluthermo Roofreflex® strip, making sure to create a rain deflector.
The joints between the strips are to be glued with DAFA UV BLACK.

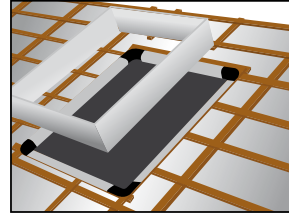
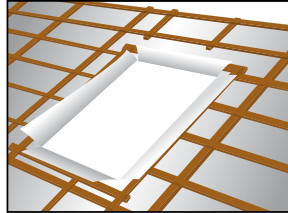
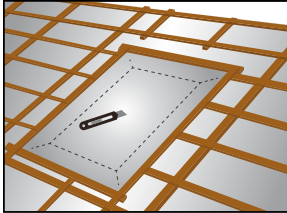

Skylight joints:
Follow the installation advice of the manufacturer of the skylight.
Draw the position of the skylight on the Aluthermo Roofreflex® and cut into the Aluthermo Roofreflex® along the two diagonals. Detach the polyester wool and fold back the membrane. Install the skylight. The wool is to be cut to frame the skylight.
Fold the membrane back over the wooden frame. Take it up to 5 cm beyond the top edge of the frame. Cut off the surplus. Glue the edges and the corners with DAFA UV BLACK.

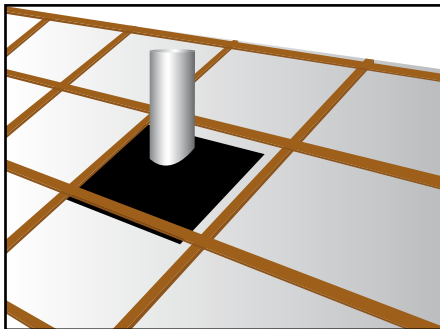

Air vent joints:
The membrane is to be cut to a slightly smaller diameter than the diameter of the air vent. The joint is to be sealed with a DAFA UNIVERSAL UNDER-ROOF COLLAR.

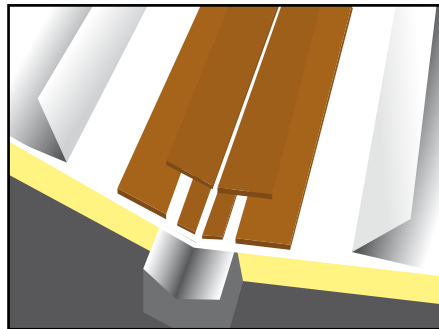

Joints in valleys:
In valleys, the Aluthermo Roofreflex® is cut along the edge. The membrane is detached for about 50 cm from the polyester wool and is folded back. The valley is constructed with boards and battens attached directly to the polyester wool. This structure is then covered with Roofreflex® jointing strip. The membrane of the Aluthermo Roofreflex® is folded back and the joints are sealed with DAFA UV BLACK.

Aluthermo - quality guaranteed



EFFECTIVE. THIN. EASY TO INSTALL.

ALUTHERMO S.A.
Steinkelt, Galhausen 23
4780 ST. VITH
BELGIUM

Tel. : +32(0)80 77 10 28
Fax : +32(0)80 54 90 29
info@aluthermo.be

www.aluthermo.com